



Project Name: **REA Cancer Treatment Center Addition/Remodel**

Project type: Medical Office Building

Address: 315 South Osteopathy  
Kirksville, Missouri

Description: The George Rea Cancer Treatment Center provides comprehensive cancer treatment services through chemotherapy and radiation therapy.

The design for the facility expansion included a 4,200 sf addition designed for patient examinations and chemotherapy treatments. The work in the original facility included minor renovation and the installation of new simulator and linear accelerator equipment.

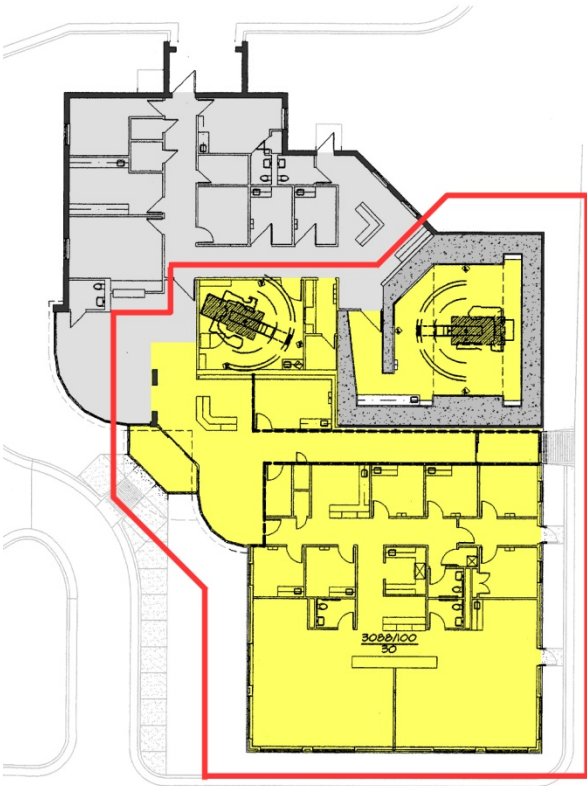

Note: This project was completed by Tim Wilson as an architect in the employ of the firm of record, WRS Architects Inc.

